

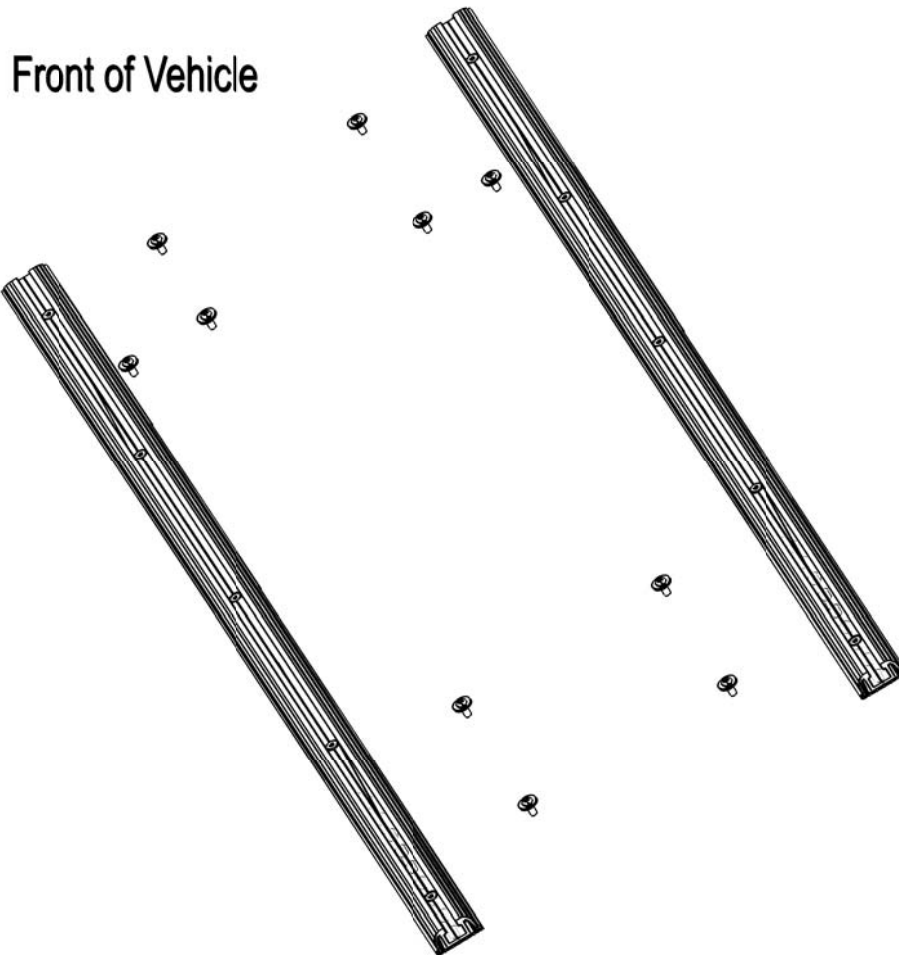

INSTALL TIME: 1.5 Hours



IMPORTANT WARNING!

IT IS CRITICAL THAT ALL FRONT RUNNER PRODUCTS BE PROPERLY AND SECURELY ASSEMBLED AND ATTACHED TO YOUR VEHICLE. IMPROPER ATTACHMENT COULD RESULT IN AN AUTOMOBILE ACCIDENT, AND COULD CAUSE SERIOUS BODILY INJURY OR DEATH TO YOU OR TO OTHERS. YOU ARE RESPONSIBLE FOR ASSEMBLING AND SECURING ALL FRONT RUNNER PRODUCTS TO YOUR VEHICLE, CHECKING THE ATTACHMENTS PRIOR TO USE, AND PERIODICALLY INSPECTING THE PRODUCTS FOR ADJUSTMENT, WEAR, AND DAMAGE. THEREFORE, YOU MUST READ AND UNDERSTAND ALL OF THE INSTRUCTIONS AND CAUTIONS SUPPLIED WITH YOUR FRONT RUNNER PRODUCT PRIOR TO INSTALLATION OR USE. IF YOU DO NOT UNDERSTAND ALL OF THE INSTRUCTIONS AND CAUTIONS, OR IF YOU HAVE NO MECHANICAL EXPERIENCE AND ARE NOT THOROUGHLY FAMILIAR WITH THE INSTALLATION PROCEDURES, YOU SHOULD HAVE THE PRODUCT INSTALLED BY A PROFESSIONAL INSTALLER OR OTHER QUALIFIED PERSONNEL.

1

GET ORGANIZED...

Here is what you are looking at:

Item#	Quantity	Description
1	10	M6 X 30 COUNTERSUNK BOLT
2	2	ROOF TRACK- 1 LEFT/1 RIGHT
3	2	RUBBER TRACK LINING
4	4	M6 CLINCH NUT
5	10	M6 X 16 BUTTON HEAD BOLT
6	10	M6 X 19 X 1 FLAT WASHER

- You will need:**
- 4 mm Hex key
 - Tube of Silicone
 - Ladder
 - Dry cloth
 - Rivnut Tool
 - Star screw driver
 - Drill machine
 - 4 mm & 9 mm Drill bit
 - Insulation tape

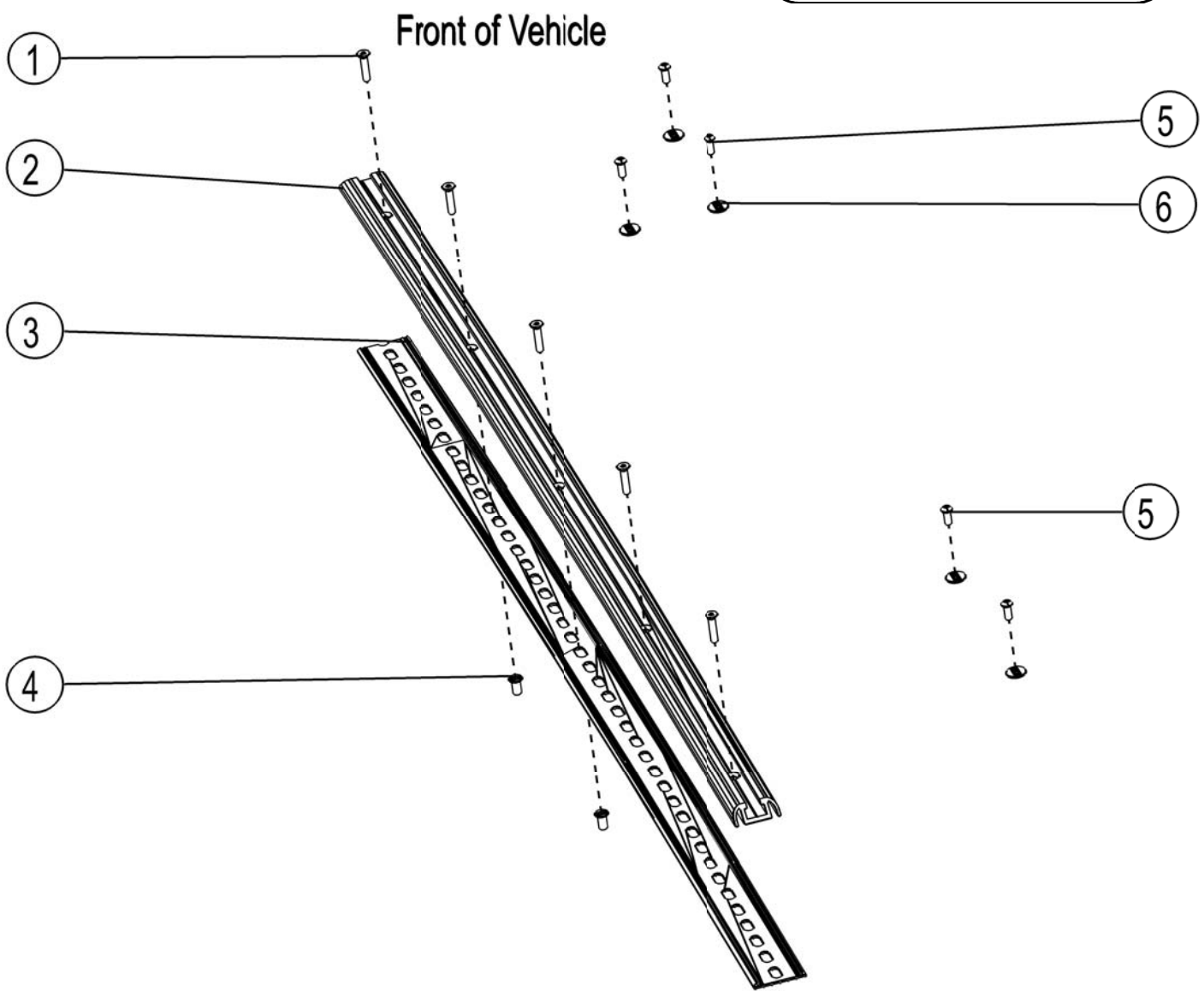

Left Hand Side Shown-Similarly For Right Hand Side

(A) Familiarize yourself with the parts and then step away from the work area and read through these instructions from beginning to end. Take a moment as little prep now may save you a lot of time later.

2 INSTALL TRACKS

- (A) Remove the original load bars from the roof. Loosen the screws using a Star screw driver.



- (B) Place the Track (Item 2) on the roof, pick up the second threaded hole from the front and line up the two threaded holes at the back.



- (C) Using a marking pen, mark the two non threaded holes for both Tracks onto the vehicle's roof and remove the Tracks from the roof.



- (D) Before drilling the holes in the roof, you need to do a bit of prep. Take both the 4 mm & 9 mm drill bits. Using some insulation tape, wrap some around the drill bit to act as a stopper to prevent you drilling too deep.

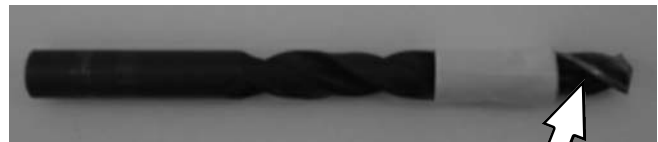

10 mm from tip of drill bit to start of tape.

Drill the 4 holes you marked earlier, starting with a 4 mm pilot hole before going to the larger 9 mm hole. There is **NO NEED** for a lot of downward pressure. Let the drill do the work - your job is to keep the drill steady - you don't want it slipping across your roof and scratching it!

- (E) Using a rivnut tool, fit the four Rivnuts (Item 4) into the holes drilled in Step 2D.



- (F) Silicone each of the ten holes where the Tracks need to be fitted.

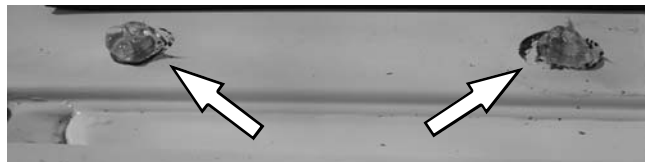

2 INSTALL TRACKS CONT...

- (G) The Tracks (Item 2) ship with the Rubber Track Liner (Item 3) loosely fitted in place. There are two quick steps to prep the Track Liners and Tracks. First, remove the paper to expose the glue. Then carefully center the holes in the Liner with the holes in the Track and press the Liner into place. Using your utility knife trim the Liner at the end of each Track so it doesn't overhang.

- (H) Place the Tracks on top of the roof, lining up all the holes. Fasten the Tracks to the roof using the M6 x30 Countersunk Bolts (Item 1) and a 4mm Hex Key.

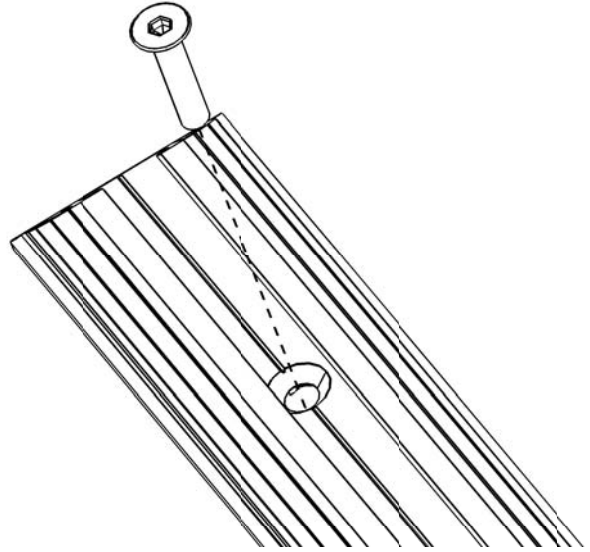

- (I) On the remaining ten threaded holes in the front and the rear of the roof, place some silicone on each hole. Insert a M6 x16 Button Head Bolt and M6 x19 x1 Flat Washer (Items 5& 6) into each hole and tighten using a 4 mm Hex key.

Using a dry clean cloth, wipe any excess silicone from the roof. Using a suitable polish, clean the roof area where the original roof rails feet used to locate.



Congratulations, you have completed your installation. Take a step back and admire your work. Good Job!